

REVISIONS				
ZONE	REV.	DESCRIPTION	DATE	APPROVED
	0	INITIAL RELEASE.	05/18/07	SCP

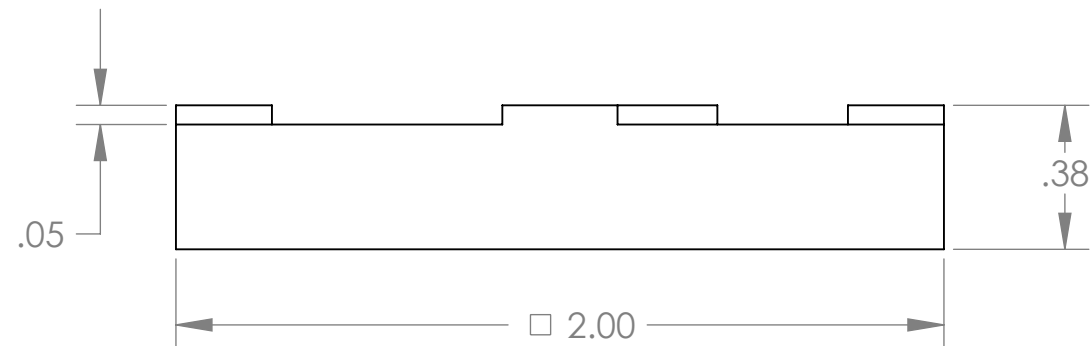
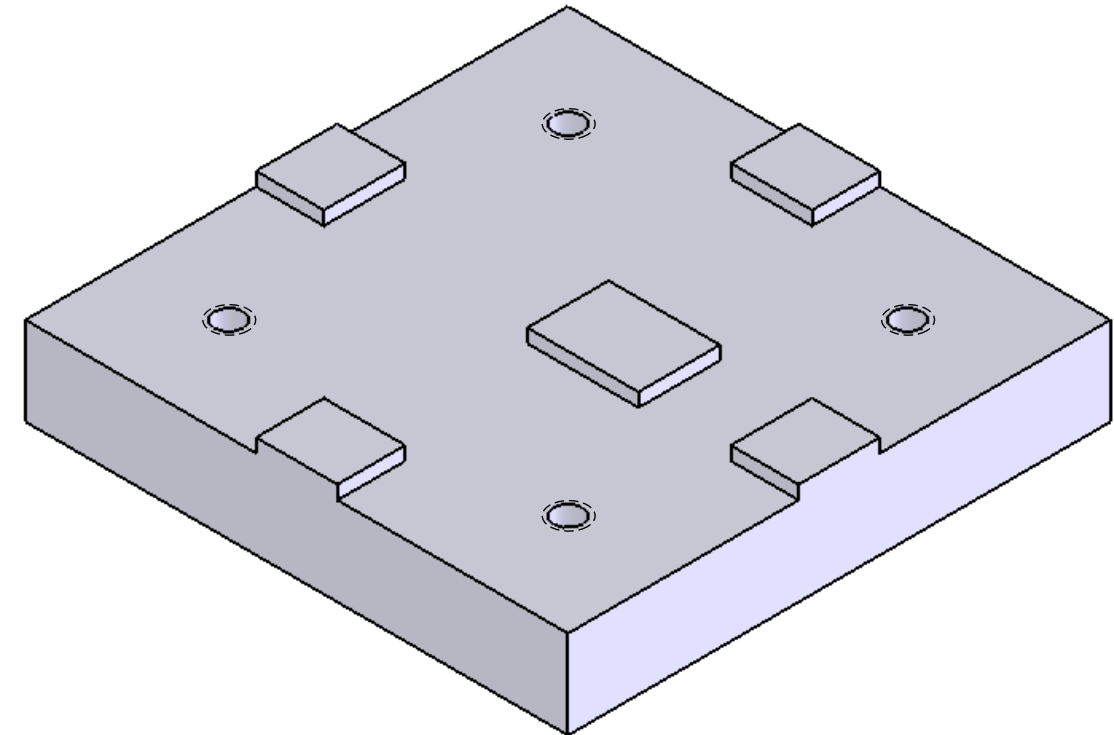
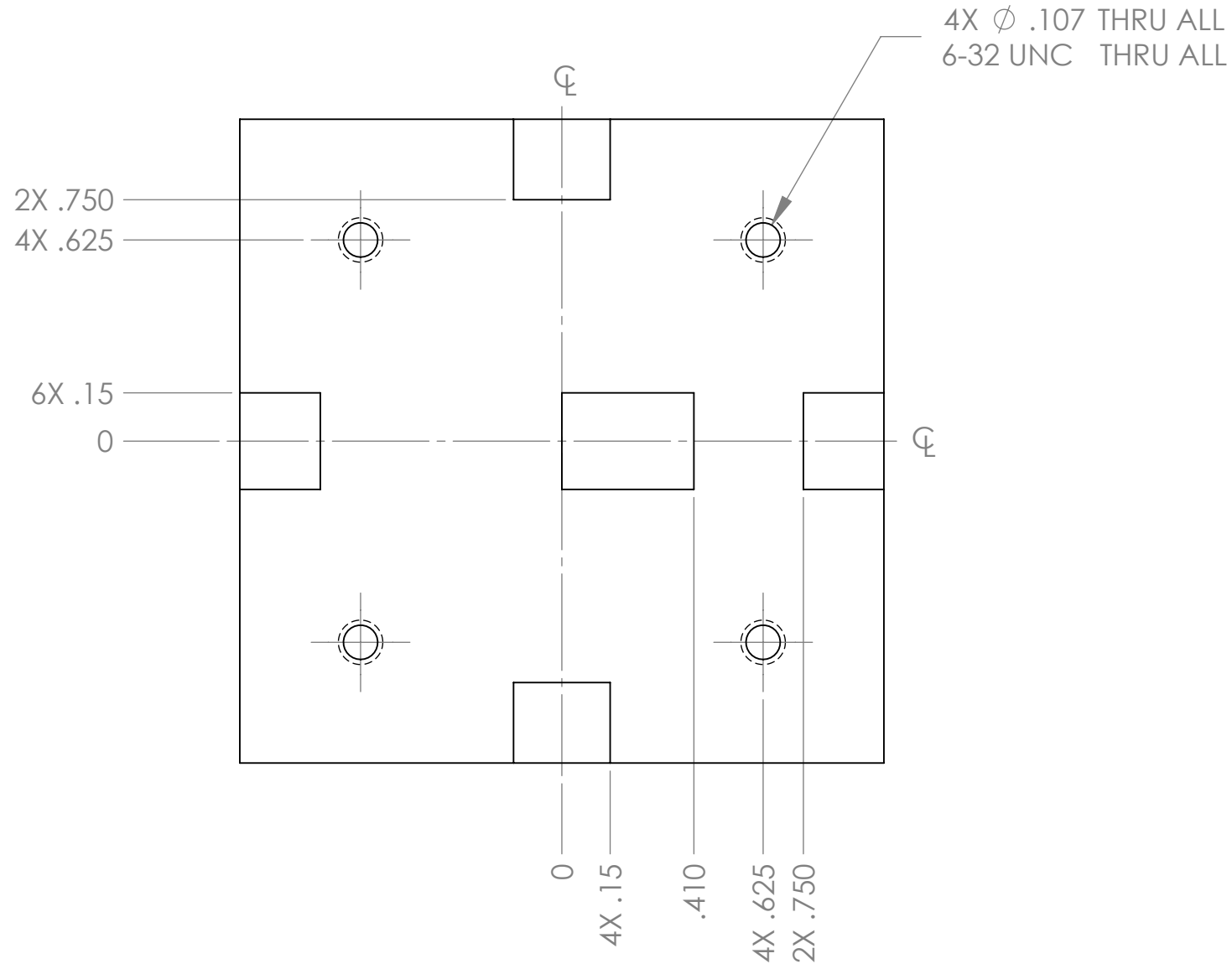

UNLESS OTHERWISE SPECIFIED DIMENSIONS ARE IN INCHES, REMOVE BURRS AND BREAK SHARP EDGES 0.005-0.010

TOLERANCES: .XX \pm .010 .XXX \pm .005
ANGLES \pm 0.5° UNLESS NOTED,
ALL SURFACES 64 UNLESS NOTED

MATERIAL: 6061-T6 ALUM
QTY: 1



NAME:	INIT.	DATE:
DRAWN:	SCP	05/18/07
CHECKED:	SCP	05/18/07
APPROVED:		
FABRICATED:		

FILE: SBB welding jig base

TRIPLESPEC

Cornell University
Center for Radiophysics and Space Research - Ithaca, NY 14853

TITLE: SBB WELDING JIG

SIZE: B DRAWING # REV 0

SCALE: 2:1 DATE: 5/18/2007 SHEET 1 OF 1