

REV.	DESCRIPTION	APPROV.	DATE

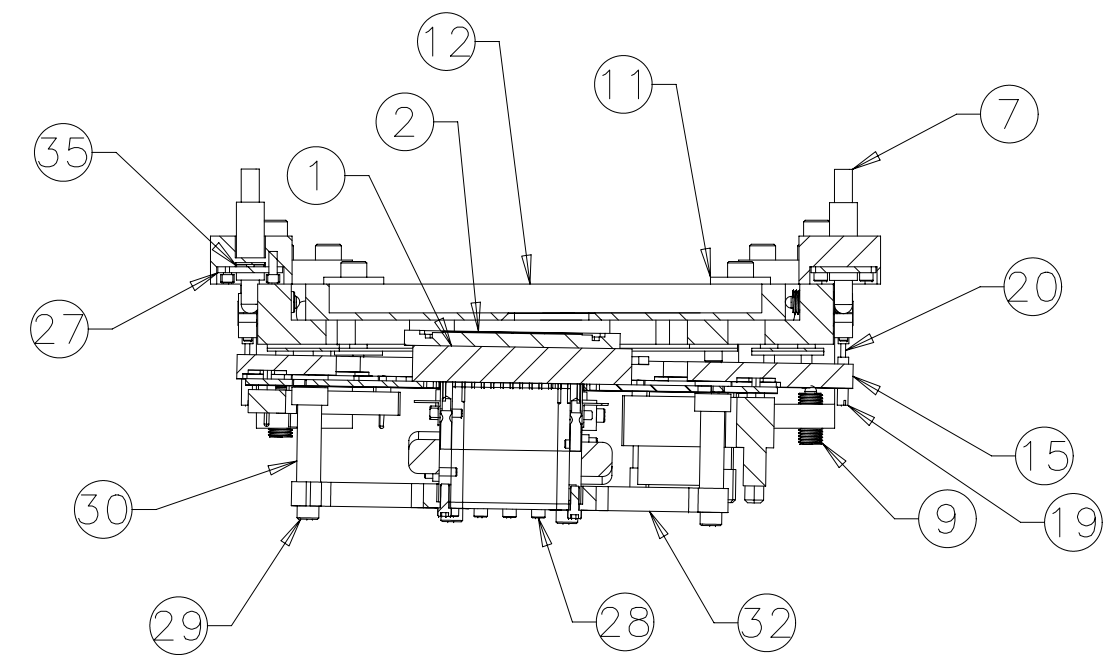
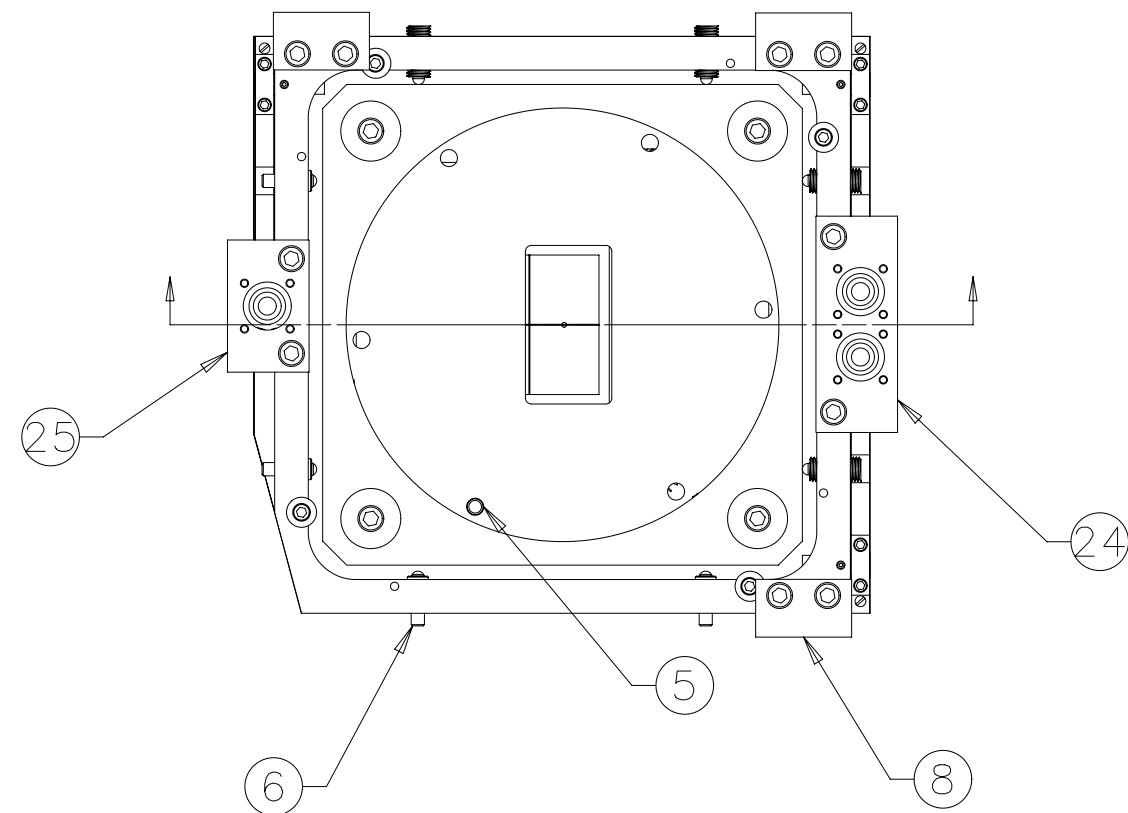

39		COLD FINGER SHUNT	1	OFC 101	
38		DIAMOND PIN .094X1/4L	1	S. S. 416	0.00
37		DOWEL PIN .094X1/4L	1	S. S. 416	0.00
36		HEATER	4	DALE RH-5	0.00
35		WAVE SPRING WASHER	3	SPEC W0484-009S	0.00
34		SET SCREW #2-56X1/8, SILVER TIP	6	BERG SC6-1	0.00
33	605014	STANDOFF, SPIDER WEB	8	S. S. 303	0.00
32	116012	SPIDER DETECTOR DEFINING	1	ALUMINUM 6061-T6	0.07
31	118019	DETECTOR COLD FINGER	1	OFC 101	0.29
30	605013	STANDOFF, SPIDER WEB	8	S. S. 303	0.00
29	505913	CAPTIVE SCREW #6-32X1-1/2	8	S. S. 303	0.00
28		SCREW H.S. HEAD #2-56X1/4	26	S. S. 303	0.00
27	111158	CLAMP PLATE	3	ALUMINUM 6061-T6	0.00
26		SCREW H.S. HEAD #4-40X1/4	16	S. S. 303	0.00
25	112122	MOUNTING BLOCK	1	ALUMINUM 6061-T6	0.05
24	112121	MOUNTING BLOCK	1	ALUMINUM 6061-T6	0.07
23	112120	SPACER BLOCK G-10	8	ALUMINUM 6061-T6	0.00
22	440014	INSULATOR DEFINING BLADE	4	G-10	0.01
21		SCREW H.S. HEAD #2-56X1/2	44	S. S. 303	0.00
20	653011	PUSH PIN	3	S. S. 303	0.00
19	503010	ADJUSTING SCREW	6	S. S. 303	0.00
18	160414	CLAMP FLEX PIVET	3	ALUMINUM 6061-T6	0.00
17		FLEX PIVOT	3	STAINLESS STEEL	0.00
16	112118	DETECTOR ADJUST BLOCK X Y RZ	1	ALUMINUM 6061-T6	0.77
15	112119	DETECTOR ADJUST BLOCK Z RX RY	1	ALUMINUM 6061-T6	0.51
14		SCREW H.S. HEAD #8-32X5/8	4	S. S. 303	0.01
13	117015	LEVER ARM	3	ALUMINUM 6061-T6	0.01
12	112117	DETECTOR MOUNT - FIXED	1	ALUMINUM 6061-T6	0.41
11		WASHER PLAIN #8 WIDE	4	S. S. 303	0.01
10		SCREW H.S. HEAD #8-32X3/4	10	S. S. 303	0.01
9		STUBBY SPRING PLUNGER	7	REID TOOL LNK-3SN	0.01
8	113097	SPRING RETAINING BRACKET	3	ALUMINUM 6061-T6	0.05
7		SQUIGGLE PIEZOELECTRIC MOTOR	3	SQ-115C	0.00
6		ADJUST SCREW 6-80, NEW FOCUS	4	S. S. 303 9342K	0.00
5		SCREW H.S. HEAD #8-32X1/2	6	S. S. 303	0.01
4		SENSOR CYROTONICS	2	DT470-CU LAKE SHORE	0.00
3	300009	FANOUT BOARD	1		0.00
2		ZIF SOCKET	1		0.00
1		HAWAII-2	1		0.00
ITEM	PART NO	DESCRIPTION	QTY	MATERIAL	WEIGHT

NIRES-D85 Infrared Physics
 CALIFORNIA INSTITUTE OF TECHNOLOGY
 Pasadena, California

UNLESS OTHERWISE SPECIFIED DIMENSIONS ARE IN INCHES .005/.010 EDGE BROKEN THREADS PER MIL-S-7742 MACHINED SURFACE 63 MAX MACHINED INSIDE CORNER R.005 MAX TOLERANCE .XX: ±.01 X/X: ±1/64 .XXX: ±.005 ANG: ±.5	SIGNATURE		DATE	TITLE	DETECTOR ASSEMBLY	
	DWN BY	SEAN LIN	9 24 06	DRAWING NUMBER	011005	REV. N/C
	CHK BY			DWG SIZE	B	SCALE 1/1
	APPR BY					SHEET 1 OF 2

NOTE :

NEXT ASSEMBLY

REV.	DESCRIPTION	APPROV.	DATE

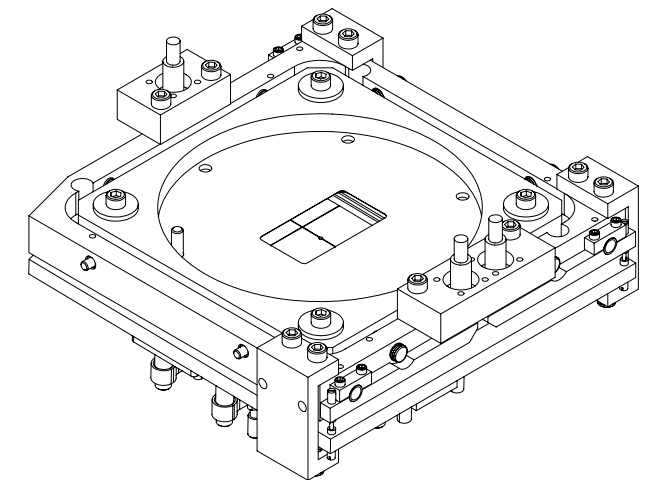
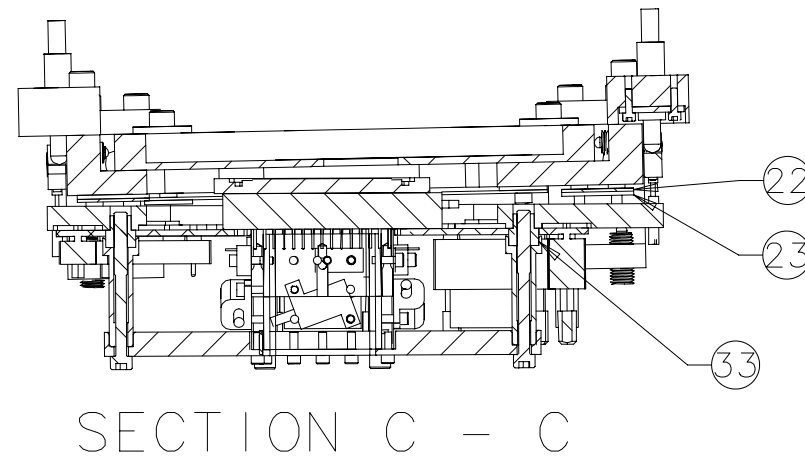
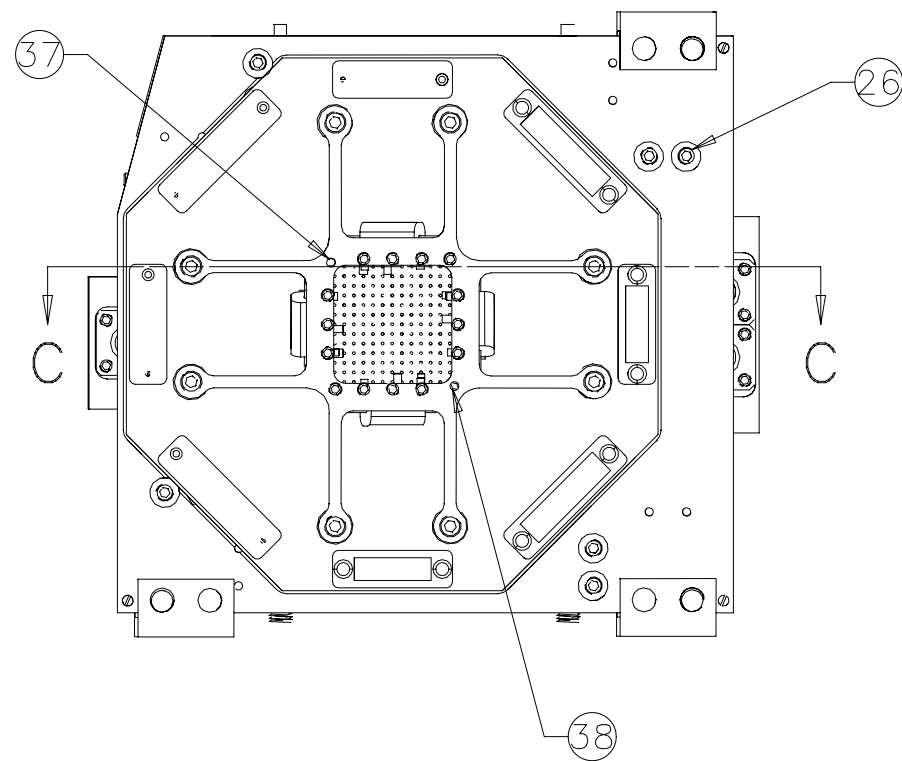
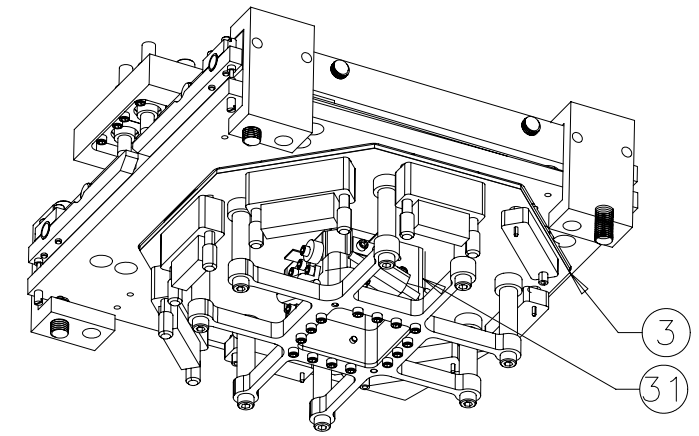
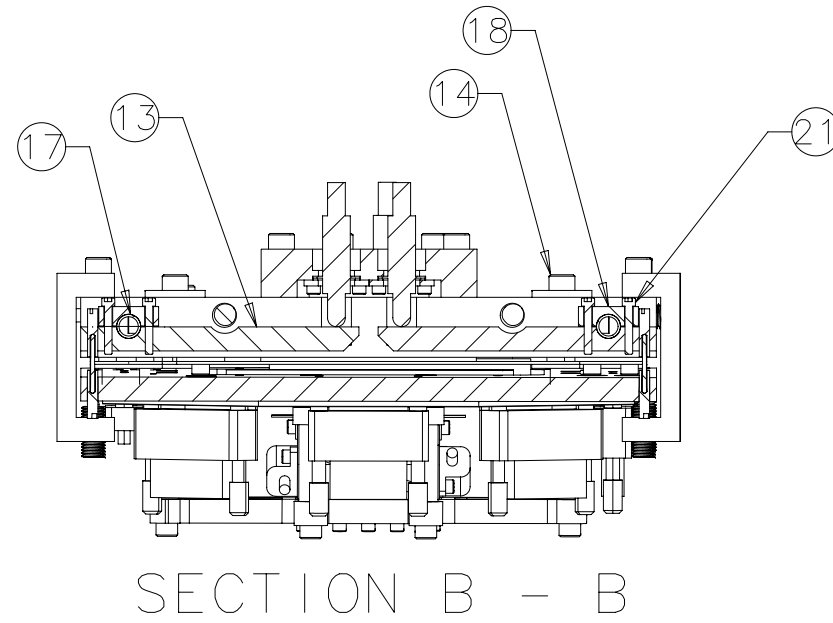
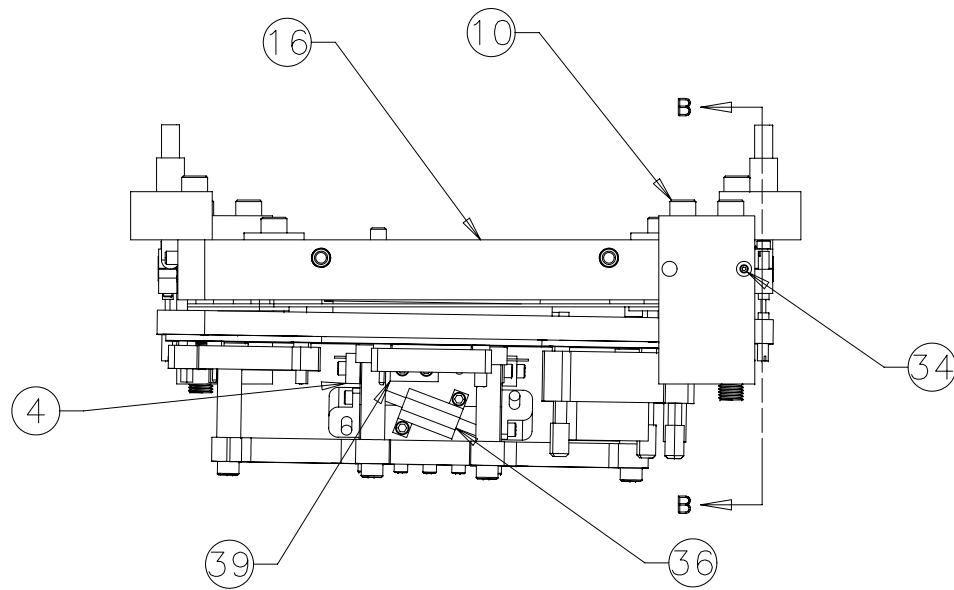

NIRES-D85

Infrared Physics
 CALIFORNIA INSTITUTE OF TECHNOLOGY
 Pasadena, California

UNLESS OTHERWISE SPECIFIED
 DIMENSIONS ARE IN INCHES
 .005/.010 EDGE BROKEN
 THREADS PER MIL-S-7742
 MACHINED SURFACE 63 MAX
 MACHINED INSIDE CORNER
 R.005 MAX
 TOLERANCE
 .XX: ±.01 X/XX: ±1/64
 .XXX: ±.005 ANG: ±.5

SIGNATURE		DATE
DWN BY	SEAN LIN	9 24 06
CHK BY		
APPR BY		

TITLE	DETECTOR ASSEMBLY	
DRAWING NUMBER	011005	REV. N/C
DWG SIZE B	SCALE 1/1	SHEET 2 OF 2

NEXT ASSEMBLY

NOTE :