

REV.	DESCRIPTION	APPROV.	DATE

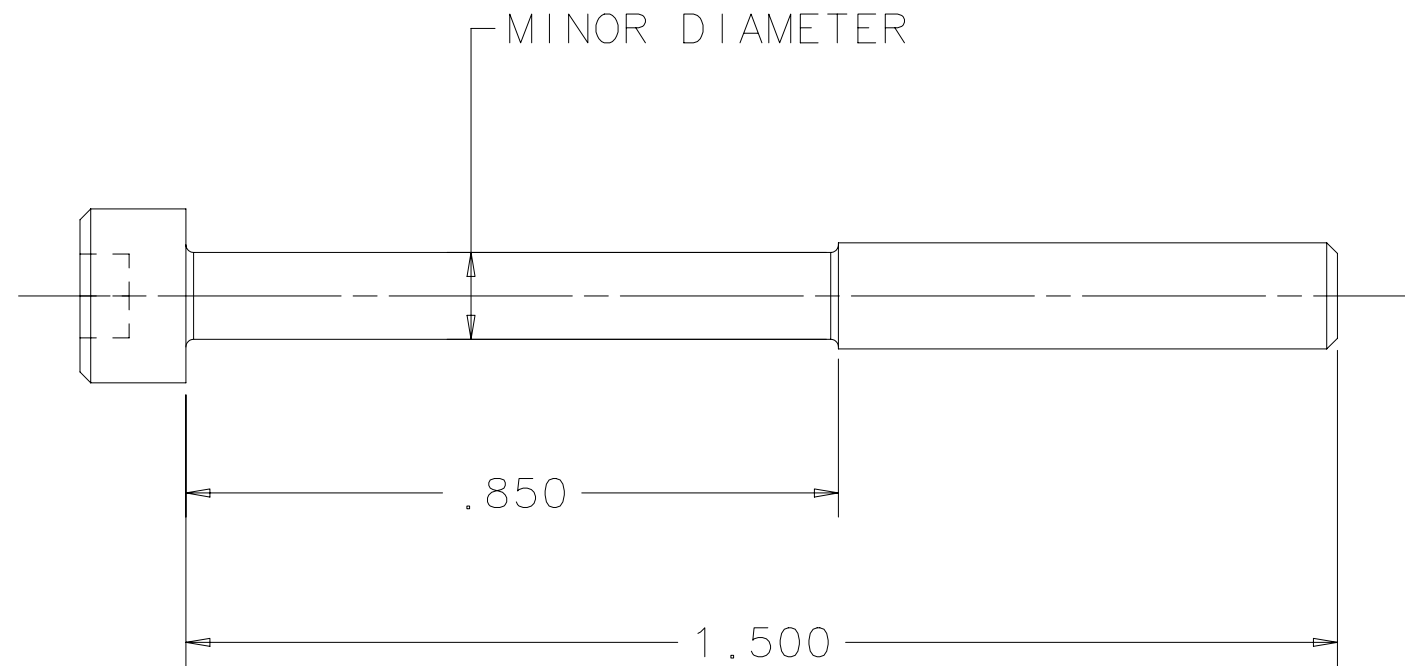
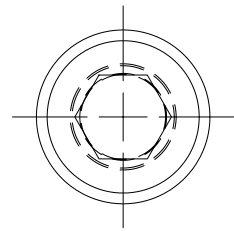

NIRES-D85

Infrared Physics
 CALIFORNIA INSTITUTE OF TECHNOLOGY
 Pasadena, California

UNLESS OTHERWISE SPECIFIED
 DIMENSIONS ARE IN INCHES
 .005/.010 EDGE BROKEN
 THREADS PER MIL-S-7742
 MACHINED SURFACE 63 MAX
 MACHINED INSIDE CORNER
 R.005 MAX
 TOLERANCE
 .XX: ±.01 X/XX: ±1/64
 .XXX: ±.005 ANG:±.5

SIGNATURE		DATE
DWN BY	SEAN LIN	9 17 06
CHK BY		
APPR BY		

TITLE	CAPTIVE SCREW	
DRAWING NUMBER	505913	REV. N/C
DWG SIZE B	SCALE 4/1	SHEET 1 OF 1

1. MATERIAL: #2-56 SOCKET HEAD CAP SCREW
 STAINLESS STEEL.

NOTE:

NEXT ASSEMBLY 011005