

REVISIONS				
ZONE	REV.	DESCRIPTION	DATE	APPROVED
	0	INITIAL RELEASE.	01/24/07	JCW
A2	1	CHANGED .929 TO .924	04/30/07	JCW

CHAMFER
.150 X 13.88°

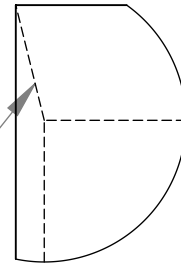

DETAIL A
SCALE 4 : 1

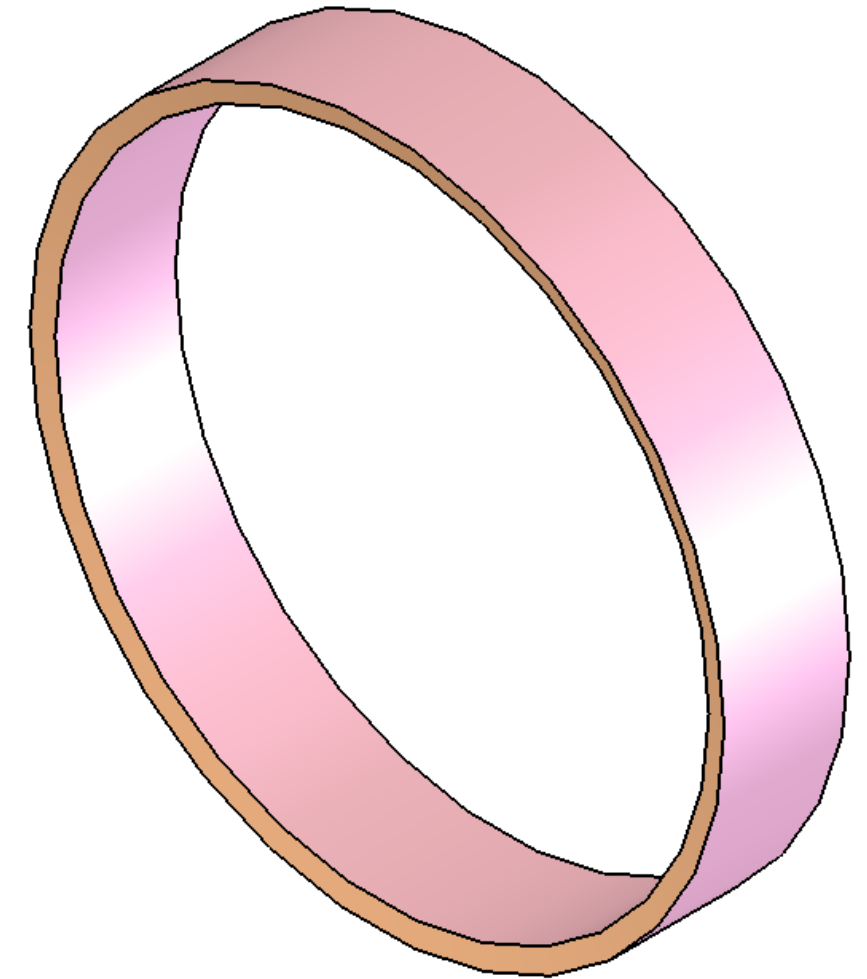
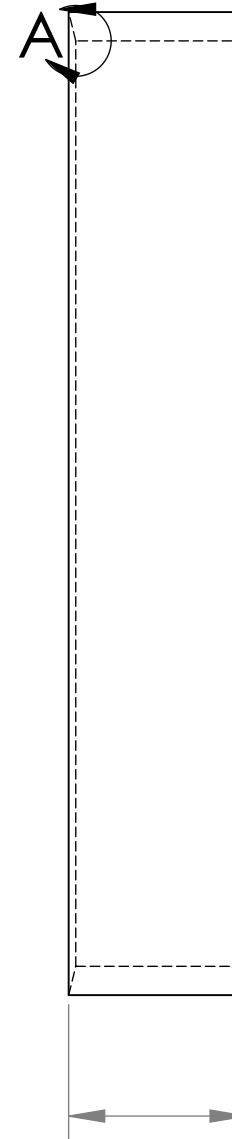
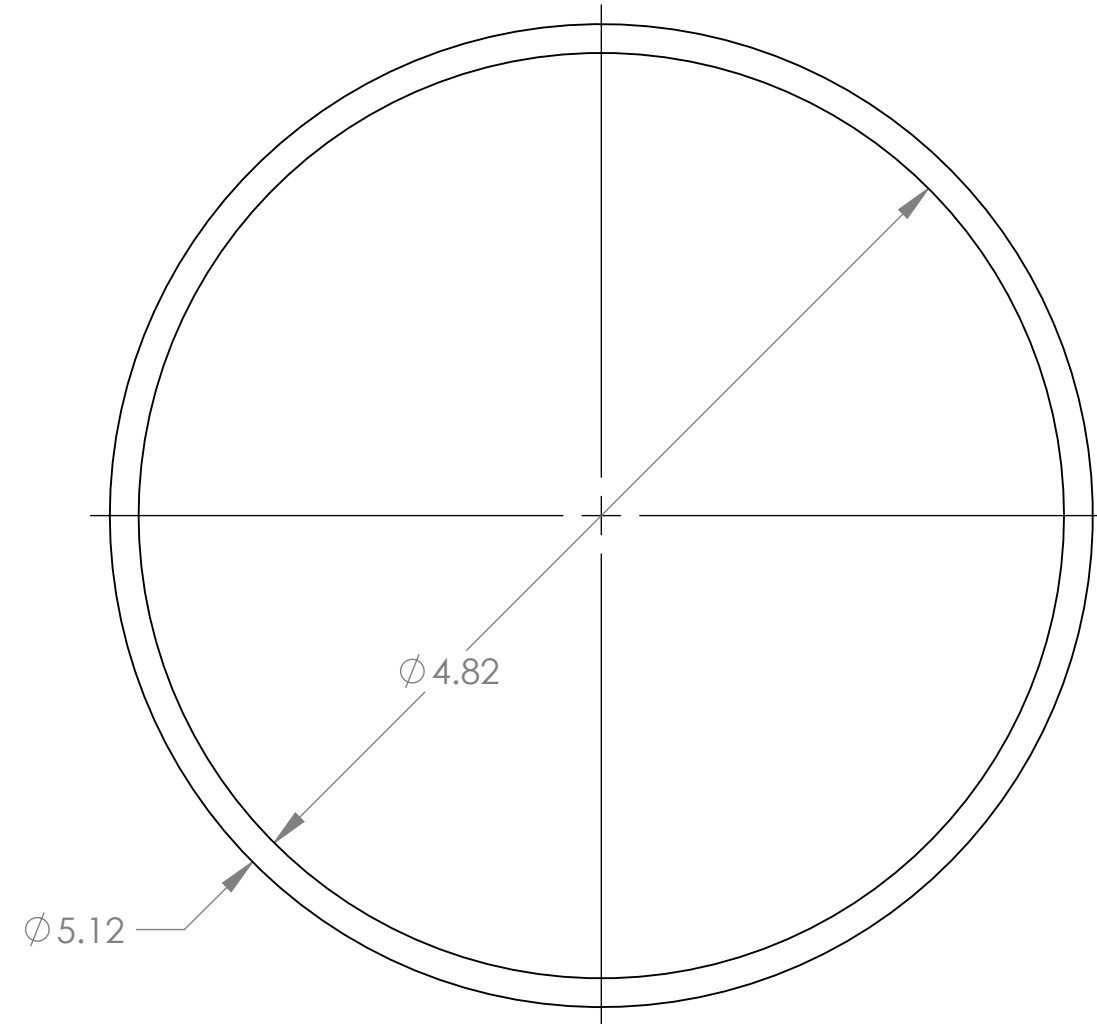

UNLESS OTHERWISE SPECIFIED DIMENSIONS
ARE IN INCHES, REMOVE BURS AND
BREAK SHARP EDGES 0.005-0.010

TOLERANCES: .XX ± .010 .XXX ± .005
ANGLES ± 0.5° UNLESS NOTED,
ALL SURFACES 64 UNLESS NOTED

MATERIAL: 6061-T6 ALUM
QTY: 1

TRIPLESPEC

NAME:	INIT.	DATE:
DRAWN:	SCP	04/30/07
CHECKED:	JCW	04/30/07
APPROVED:		
FABRICATED:		

FILE: TRDSV28-lens1-bevel-ring-apo

Cornell University
Center for Radiophysics and Space Research - Ithaca, NY 14853

TITLE: LENS1 BEVEL RING APO

SIZE: B DRAWING # TRDSV28 REV 1

SCALE: 1:1 DATE: 4/30/2007 SHEET 1 OF 1